

# Intara CX

Article number: 51410016

## LIGHT TECHNOLOGY

LED	COB
Light colour	927
Luminous flux	1290 lm
System power	15 W
Luminaire Efficiency	83 lm/W
Reflector	Downlight
Beam angle	60°

## LUMINAIRE

Weight	0.67 kg
Protection rating . class	IP20 . III
Luminaire colour	white

## OPTIONAL

RAL-colours, NCS-colours (powder coating or wet spraying) on inquiry, surface alloys on inquiry, honeycomb louver

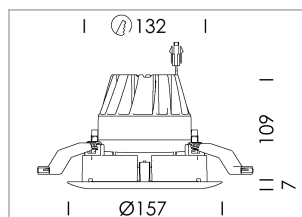

Recessed downlight with LED, rated life of the LED L80/B10 > 50000 h, colour rendering index CRI > 90, chromaticity tolerance 2 SDCM (initial), reflector with homogeneous light distribution pattern, diffuser lens, translucent, darklight reflector, aluminium, metallised, highgloss, luminaire head die-cast aluminium, powder-coated, mounting ring die-cast aluminum, front ring and coverblind plastic, white, separate driver unit

76500050 driver unit, Fix Current, 220-240 V / 50-60 Hz, 400 mA, camera-compatible, up to 2.5 KV interference resistance, SELV, max. 34 luminaires per circuit (B16A fuse)

76500051 driver unit, DALI, 220-240 V / 50-60 Hz, 400 mA, with GST18/5-pin connector, incl. 5-conductor feed-through wiring, camera-compatible, up to 2.5 KV interference resistance, SELV, max. 24 luminaires per circuit (B16A fuse)

Note: All data are typical values. System features may change with product improvements due to technical advances. Errors excepted.

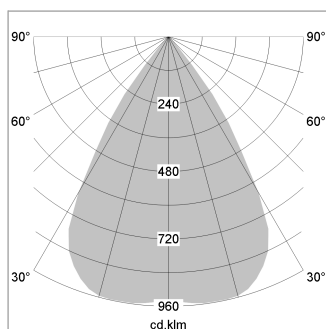

1.0 m	1.28	1215.9
2.0 m	2.56	304.0
3.0 m	3.84	135.1
4.0 m	5.12	76.0
5.0 m	6.40	48.6
Ø (m)	E0(0°) [lx]	

